

MODEL: 3544

Dual 2.5 & Single 3.5 Inch SATA HDD/SSD to 5.25 Inch Converter

Getting Started

Thank you for purchasing ineo 3544 Dual 2.5 & Single 3.5 Inch SATA HDD /SSD To 5.25 Inch Converter. This quick install guide provides step-by-step installation instructions and other important information regarding your ineo product. For the latest ineo product information and news, please visit our website at <http://www.ineo-usa.com>

Package Contents

3544	Dual 2.5 & Single 3.5 Inch SATA HDD /SSD to 5.25 Inch Converter
Holding Screws	Yes
Guarantee Card	Yes
User Manual	Yes

System Requirements

Hardware

Pentium® II, 200 MHz equivalent or newer for IBM compatible PC
PowerPC G4, 350 MHz or newer for PowerPC-based Apple Computer
Core® or newer for Intel-based Apple Computer

Software

Windows 2000/Mac9.1/Linux for USB2.0
Windows XP / VISTA / 7 / 8 / 8.1 / 10 & Mac OS X v.10.2+ for USB3.0

Note: For highest performance and reliability, ineo recommends that you install the latest service pack (SP) and updates.

■ Updating Your Operating System

Windows

Go to the Start menu and select Windows updates. For more information regarding updating your system, visit <http://windowsupdate.microsoft.com>.

Macintosh

Go to the Apple menu and select Software Update. For more information regarding updating your system, visit <http://www.apple.com/macosx>.

■ Handling Precautions

Ineo products are precision instruments and must be handled with care during unpacking and installation. Drives may be damaged by rough handling, shock, or vibration. Be aware of the following precautions when unpacking your ineo external storage kit:

- ▶ Do not unpack the product until you are ready to install it.
- ▶ Do not drop or jolt the product.
- ▶ Do not move the external storage when it is powered up.

Hard Disk Drive Installation

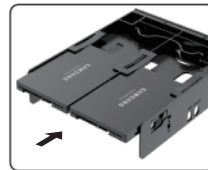

1. Insert 1 or 2.5 inch HDD/SSD from the back.

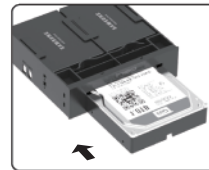

2. Insert the 3.5 inch HDD from the front.

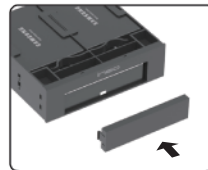

3. Close the cover.



4. Put the converter into 5.25 inch bay of chassis and lock with screws.